



# Side Kick Select 500/750

High Volume Booster Pump Kits

The compact package design allows maximum space for tank or compartments by moving the pump system below the chassis top of frame. This frees up the space above the frame for a full width of the apparatus tank or body design. The added flexibility of this design allows for a lower center of gravity for improved vehicle handling and safety. With the addition of the select program, it simplifies the order and design while providing a price advantage.

## STANDARDIZED PANEL LAYOUT

Comes with the Class1 TPG governor and ITL-40 tank level gauge to provide a compact and easy to use package with a high visibility for monitoring the system.

## STAINLESS PANEL AND PLUMBING

Package includes a stainless steel pump panel, which can be installed in the side compartment or can be hung below the apparatus body as a free standing panel on a simple frame with brackets. All stainless steel plumbing and manifolds for maximum corrosion resistance

## NFPA 1901 500 OR 750 GPM RATINGS

System exceeds current and proposed ISO 9 ratings along with NWCG Tactical Tender and Type 3 requirements. Designed to easily incorporate into the running board of tankers, Midi pumpers, RUI, Rescues, and Initial attack apparatus.

### Pre-Engineered

Pre-designed panels and plumbing configurations for ease of engineering. Predetermined driveline target zone.

### Streamlined Ordering Process

Reduction of millions of different possible configurations down to 24 different combinations.

### Price Advantage

Side Kick Select kits offer only the most popular options which are offered at a more competitive price. The simplified design can also result in savings during the design and build process.

### Optional Features

- Upgrade to 750 GPM MBP Pump
- ITL-40 in either red, green, blue, or multicolor
- Third 2.5" discharge (required with MBP)
- 1.5" Air Actuated Hose Reel

Hale Products, Inc.

800.533.3569 | [haleproducts.com/sidekickselect](http://haleproducts.com/sidekickselect)



# Sidekick Select

## Typical Installation Configuration

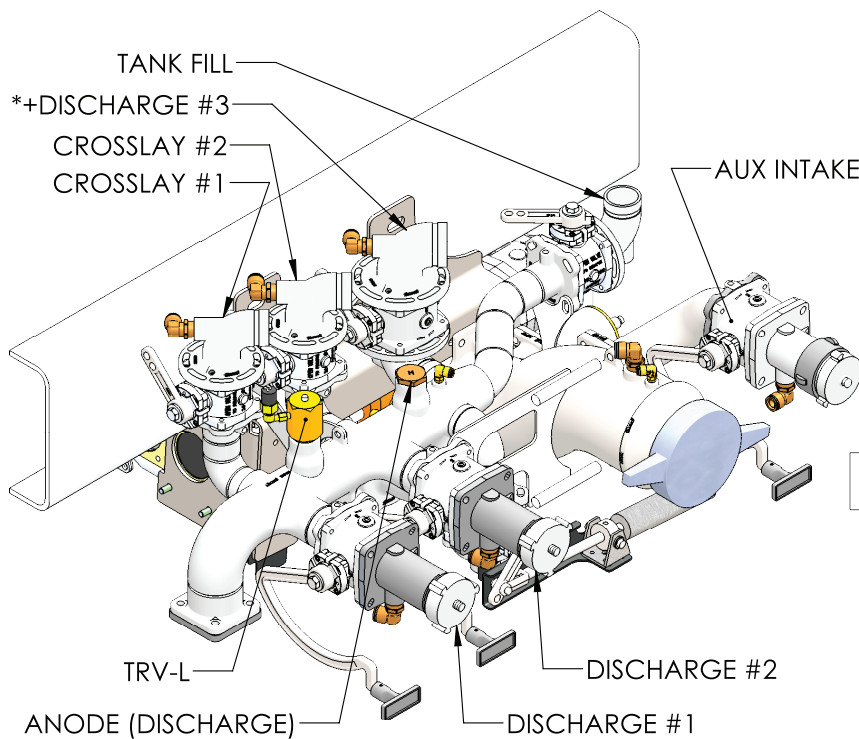
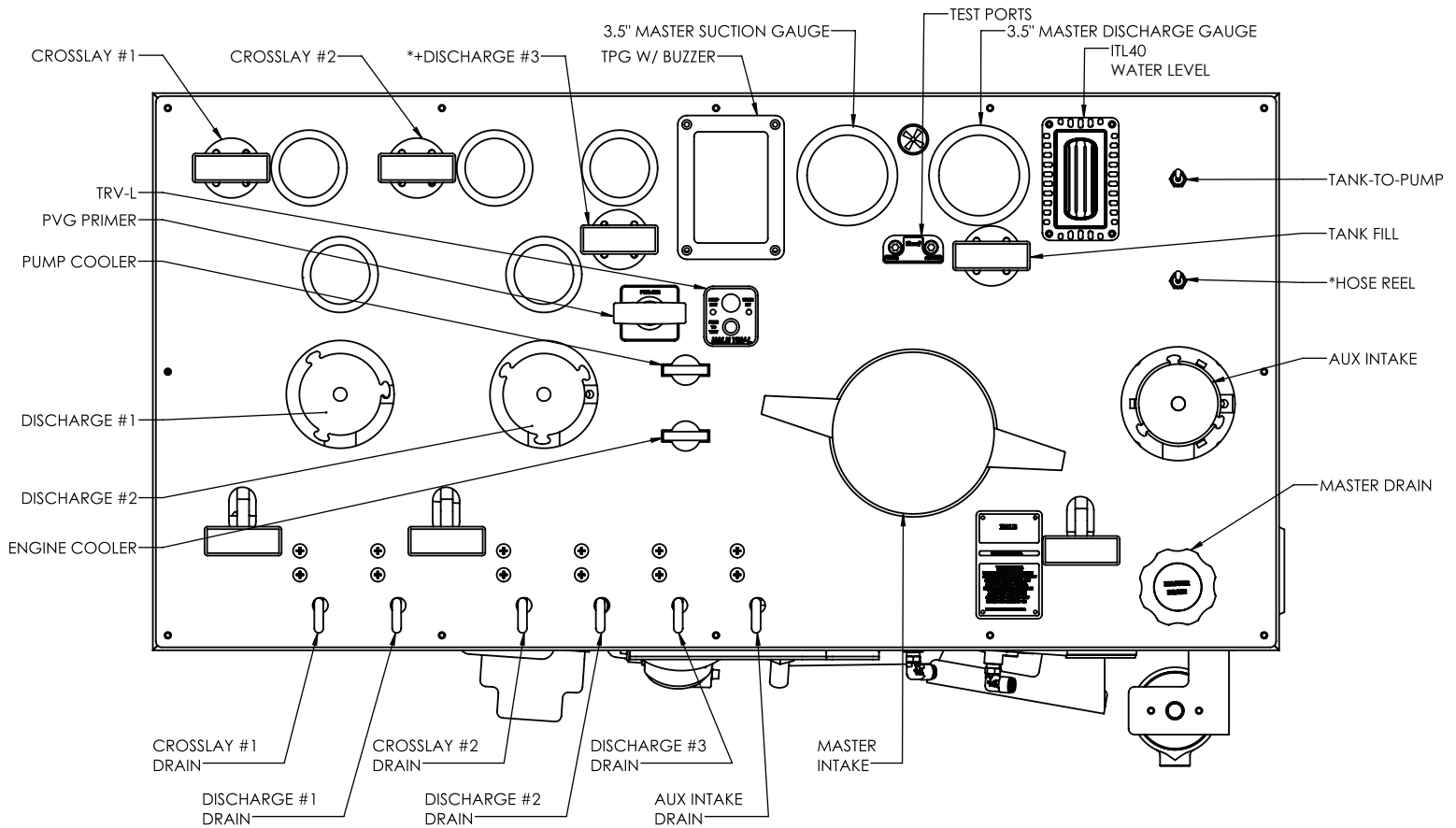

**\*OPTIONAL  
+INCLUDED ON SK750 SELECT**

VALVE	SIZE
DISCHARGE #1	2.5"
DISCHARGE #2	2.5"
*+DISCHARGE #3	2.5"
CROSSLAYS	2.0"
*HOSE REEL	1.5"
TANK FILL	2.0"
TANK-TO-PUMP	3.0"
AUX INTAKE	2.5"
MASTER INTAKE	5.0"