 607 NW 27th Ave Ocala, FL 34475 Phone : (352) 629-5020 Fax : (352)-629-2902	REBUILD INSTRUCTIONS (PRELIMINARY)				P/N	SB-161
	TYPE	INTAKE RELIEF VALVE			PAGE	1 OF 9
	DEPARTMENT	ACCESSORIES	BY	SEAN LYONS	REV	A

The following tools and supplies are required to complete this procedure:

- Small adjustable crescent wrench
- Large adjustable crescent wrench up to 1-3/8" span
- Channel locks
- Flat head screwdriver
- Anti-seize
- Alcohol
- Clean rag

All replacement parts are to be ordered separately, in the intake relief valve rebuilt kit, which include:

- 073-00015-000 replacement piston
- 097-2620-00-0 sealing washer
- 040-8260-00-0 o-ring
- 142-0390-00-0 square-cut o-ring seal

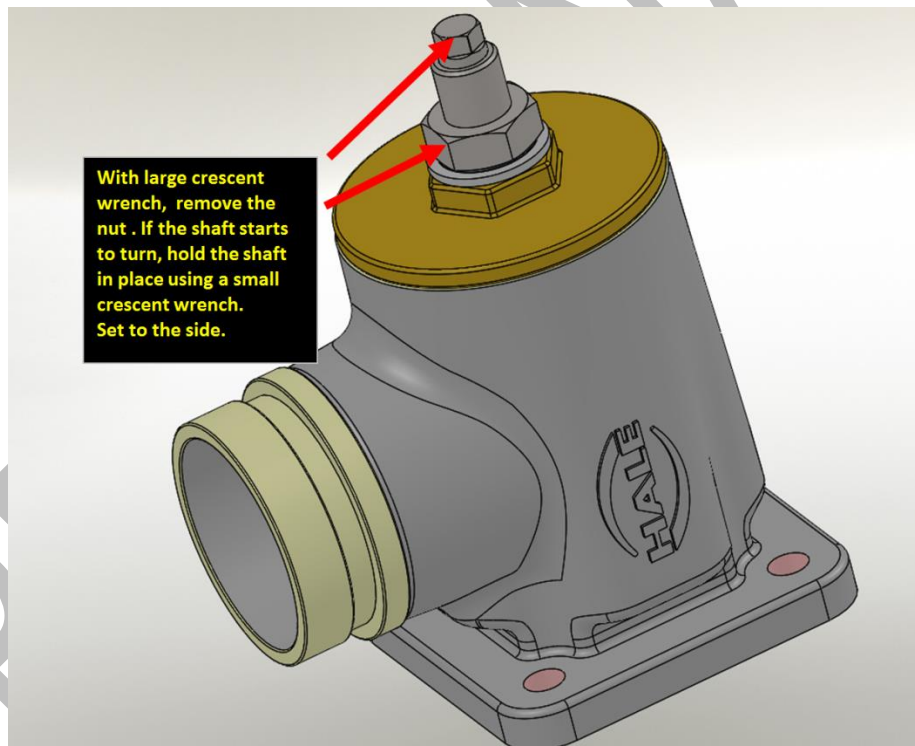

REV	DATE	BY	DESCRIPTION	Approved By
A	13FEB2018	SBL	PRELIMINARY	

 607 NW 27th Ave Ocala, FL 34475 Phone : (352) 629-5020 Fax : (352)-629-2902	REBUILD INSTRUCTIONS (PRELIMINARY)				P/N	SB-161
	TYPE	INTAKE RELIEF VALVE			PAGE	2 OF 9
	DEPARTMENT	ACCESSORIES	BY	SEAN LYONS	REV	A

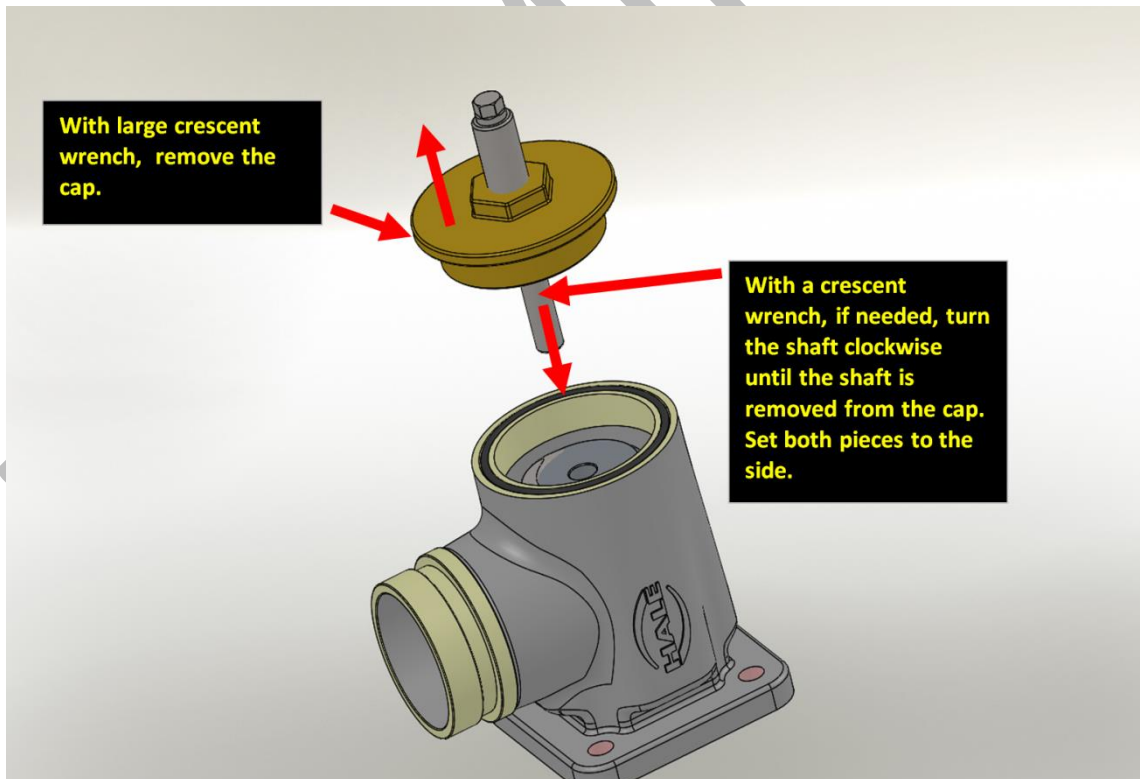
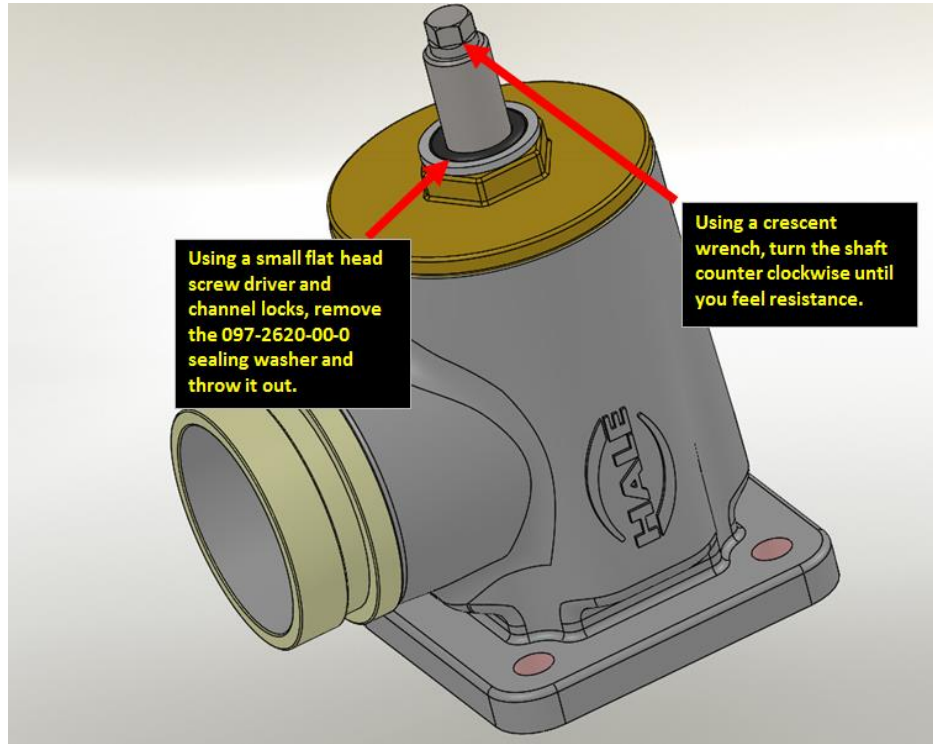

REV	DATE	BY	DESCRIPTION	Approved By
A	13FEB2018	SBL	PRELIMINARY	

 607 NW 27th Ave Ocala, FL 34475 Phone : (352) 629-5020 Fax : (352)-629-2902	REBUILD INSTRUCTIONS (PRELIMINARY)				P/N	SB-161
	TYPE	INTAKE RELIEF VALVE			PAGE	3 OF 9
	DEPARTMENT	ACCESSORIES	BY	SEAN LYONS	REV	A

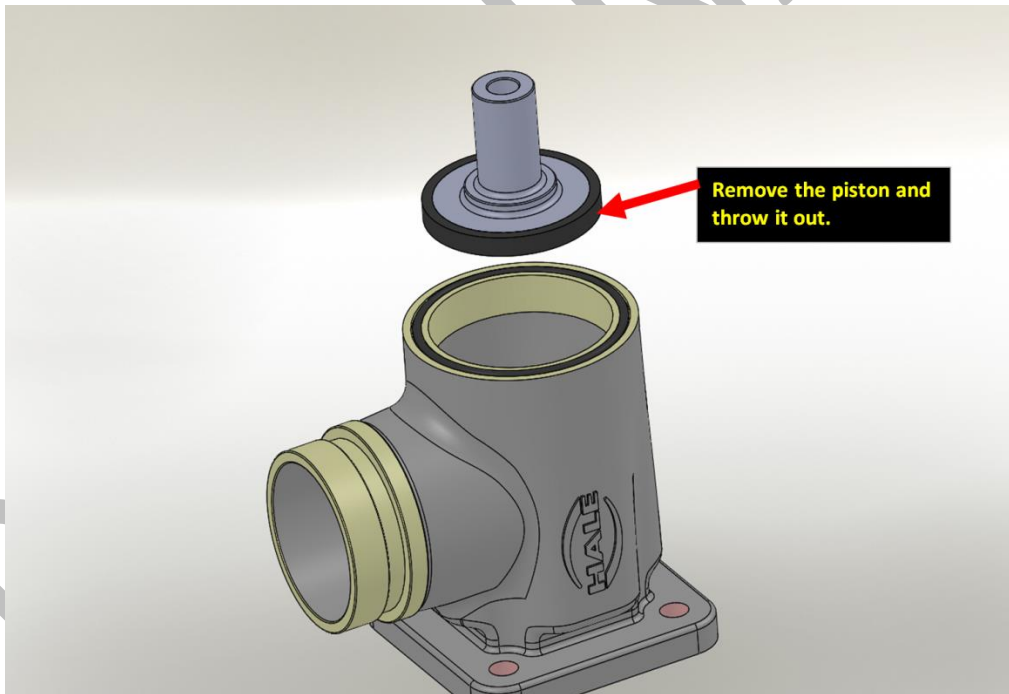
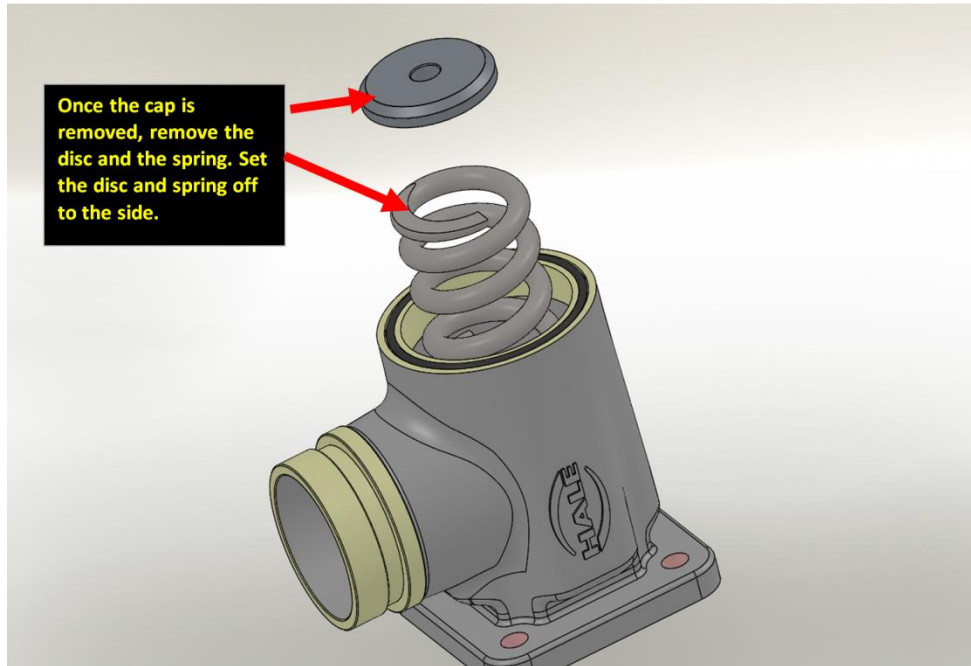

REV	DATE	BY	DESCRIPTION	Approved By
A	13FEB2018	SBL	PRELIMINARY	

 607 NW 27th Ave Ocala, FL 34475 Phone : (352) 629-5020 Fax : (352)-629-2902	REBUILD INSTRUCTIONS (PRELIMINARY)				P/N	SB-161
	TYPE	INTAKE RELIEF VALVE			PAGE	4 OF 9
	DEPARTMENT	ACCESSORIES	BY	SEAN LYONS	REV	A

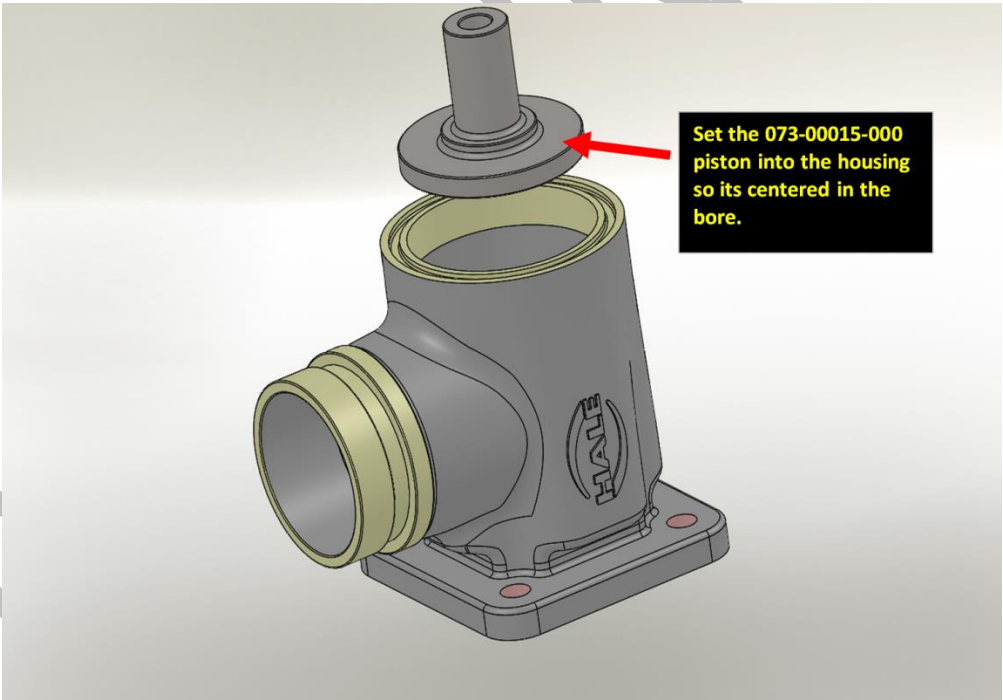
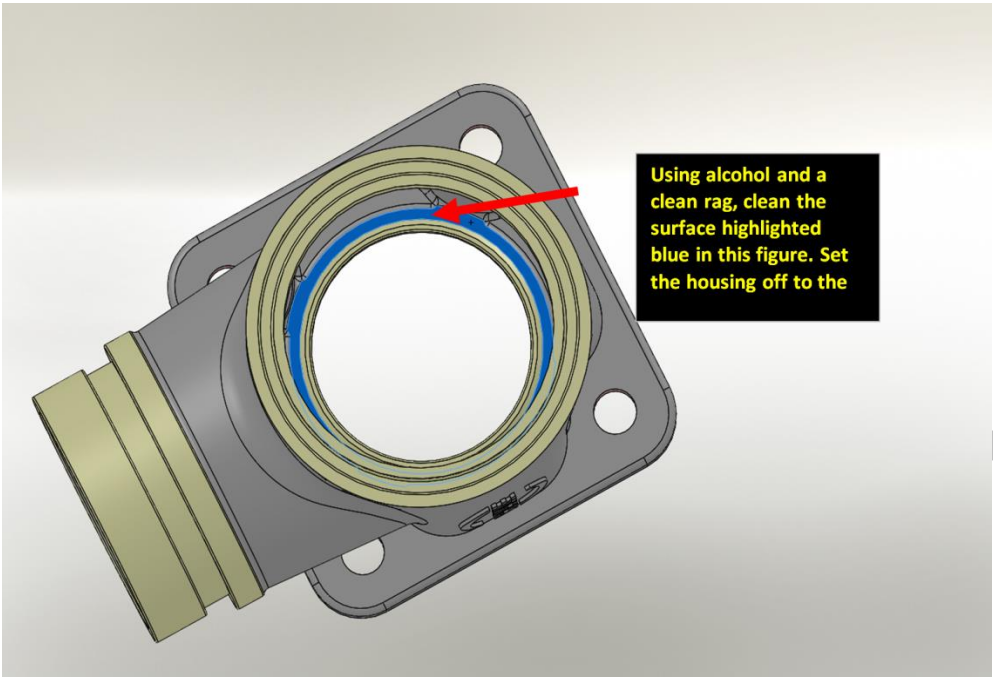

REV	DATE	BY	DESCRIPTION	Approved By
A	13FEB2018	SBL	PRELIMINARY	

 607 NW 27th Ave Ocala, FL 34475 Phone : (352) 629-5020 Fax : (352)-629-2902	REBUILD INSTRUCTIONS (PRELIMINARY)				P/N	SB-161
	TYPE	INTAKE RELIEF VALVE			PAGE	5 OF 9
	DEPARTMENT	ACCESSORIES	BY	SEAN LYONS	REV	A

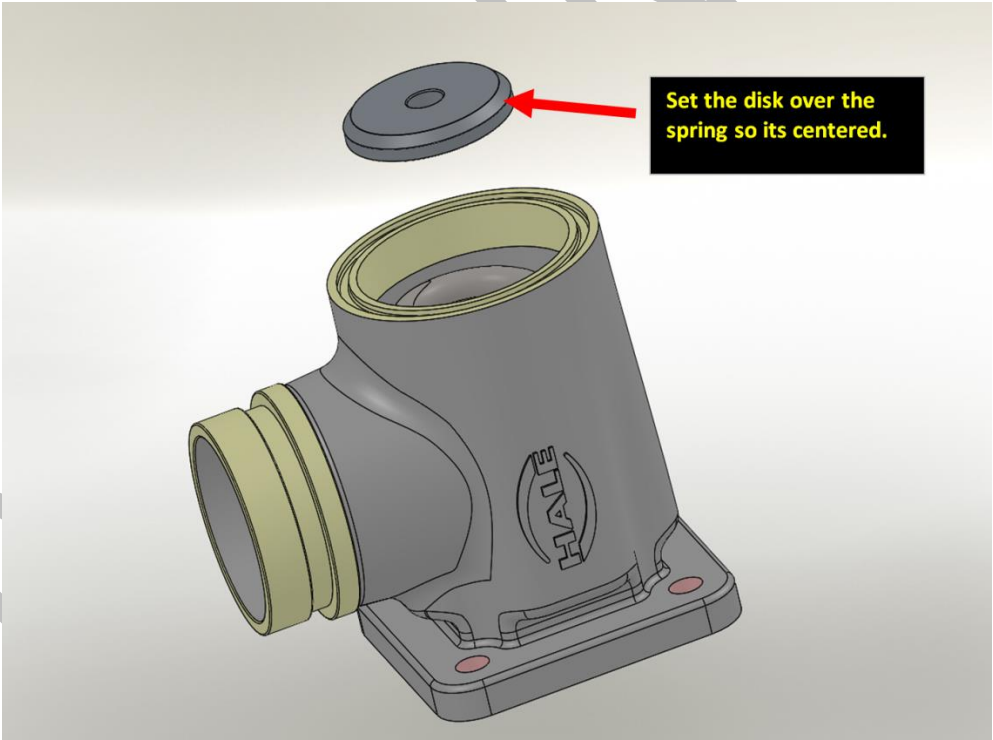
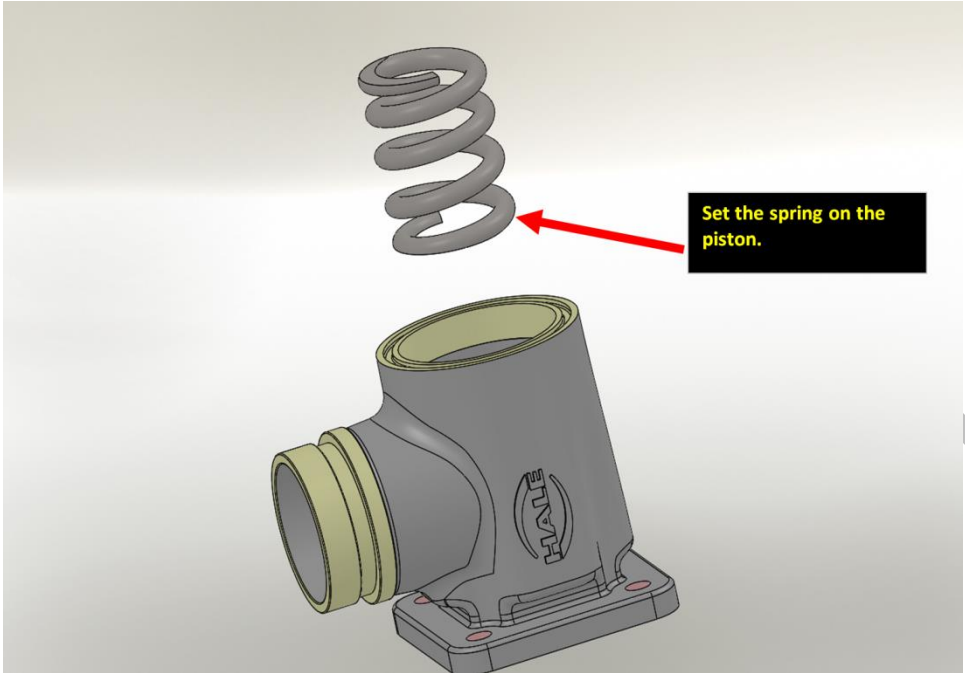

REV	DATE	BY	DESCRIPTION	Approved By
A	13FEB2018	SBL	PRELIMINARY	

 607 NW 27th Ave Ocala, FL 34475 Phone : (352) 629-5020 Fax : (352)-629-2902	REBUILD INSTRUCTIONS (PRELIMINARY)				P/N	SB-161
	TYPE	INTAKE RELIEF VALVE			PAGE	6 OF 9
	DEPARTMENT	ACCESSORIES	BY	SEAN LYONS	REV	A

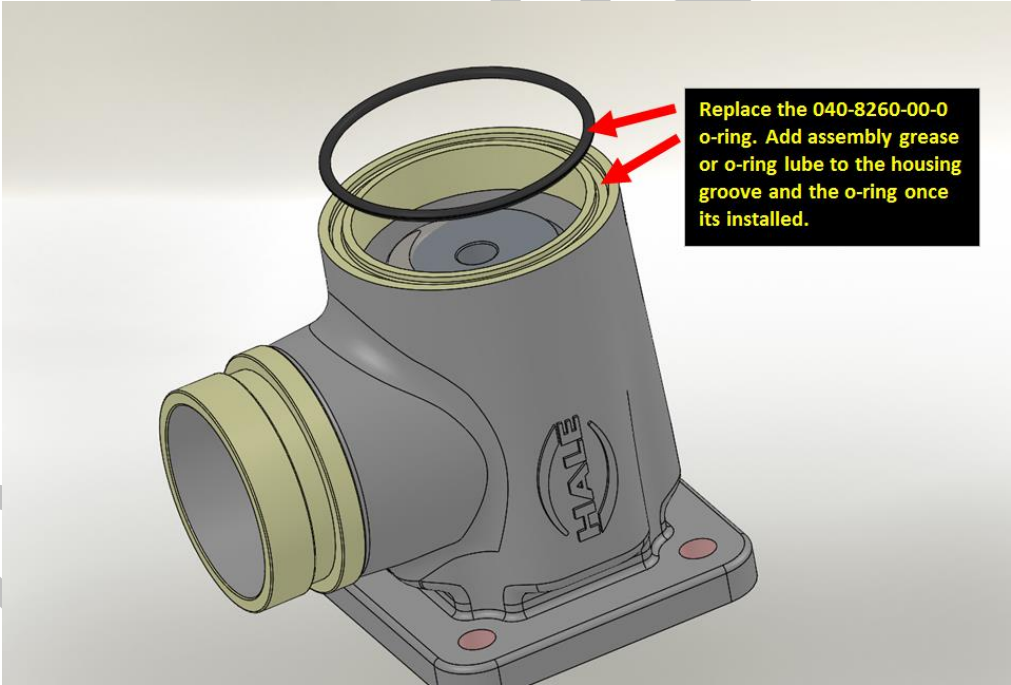
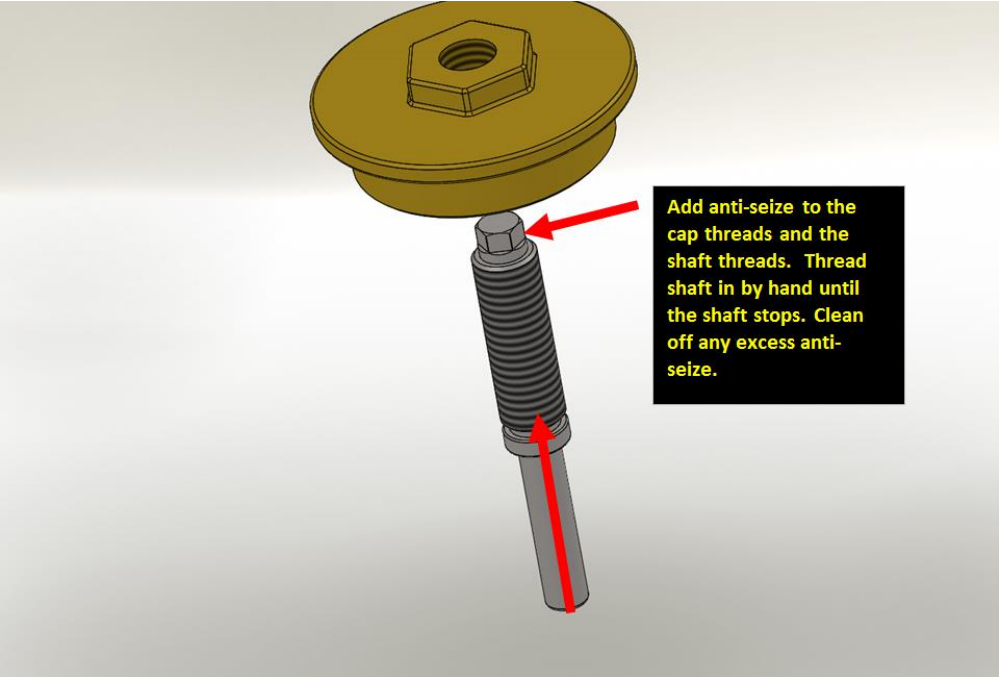

REV	DATE	BY	DESCRIPTION	Approved By
A	13FEB2018	SBL	PRELIMINARY	

 607 NW 27th Ave Ocala, FL 34475 Phone : (352) 629-5020 Fax : (352)-629-2902	REBUILD INSTRUCTIONS (PRELIMINARY)				P/N	SB-161
	TYPE	INTAKE RELIEF VALVE			PAGE	7 OF 9
	DEPARTMENT	ACCESSORIES	BY	SEAN LYONS	REV	A

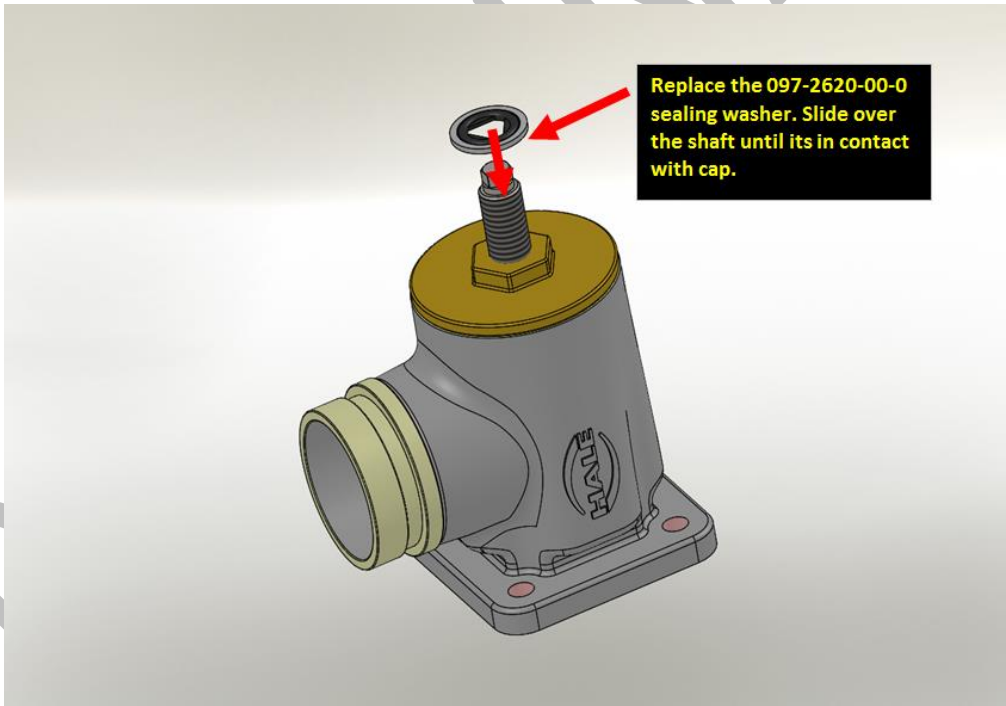
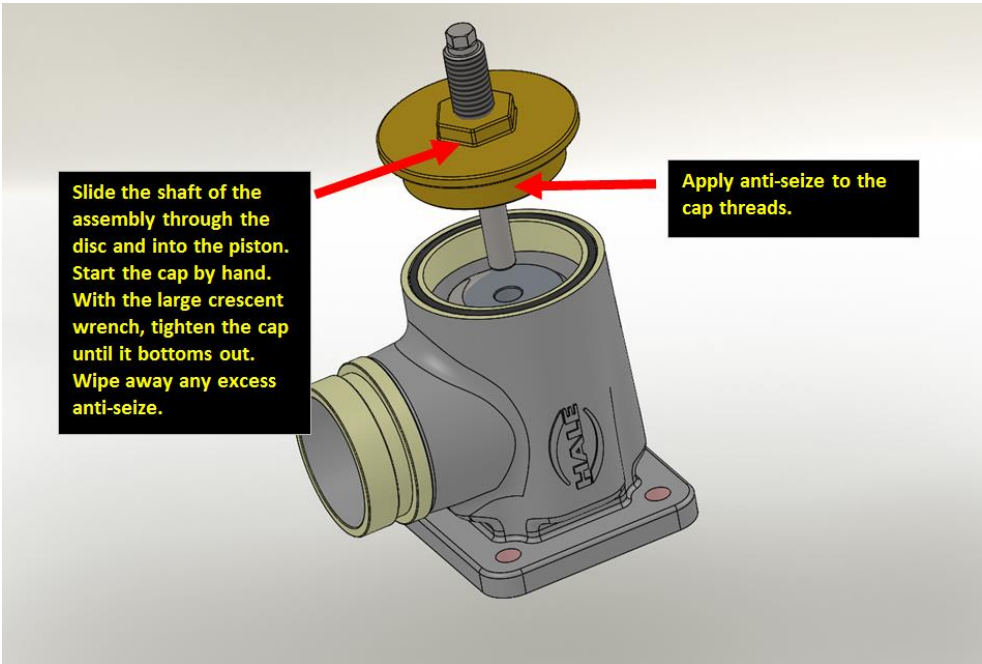

REV	DATE	BY	DESCRIPTION	Approved By
A	13FEB2018	SBL	PRELIMINARY	

 607 NW 27th Ave Ocala, FL 34475 Phone : (352) 629-5020 Fax : (352)-629-2902	REBUILD INSTRUCTIONS (PRELIMINARY)				P/N	SB-161
	TYPE	INTAKE RELIEF VALVE			PAGE	8 OF 9
	DEPARTMENT	ACCESSORIES	BY	SEAN LYONS	REV	A

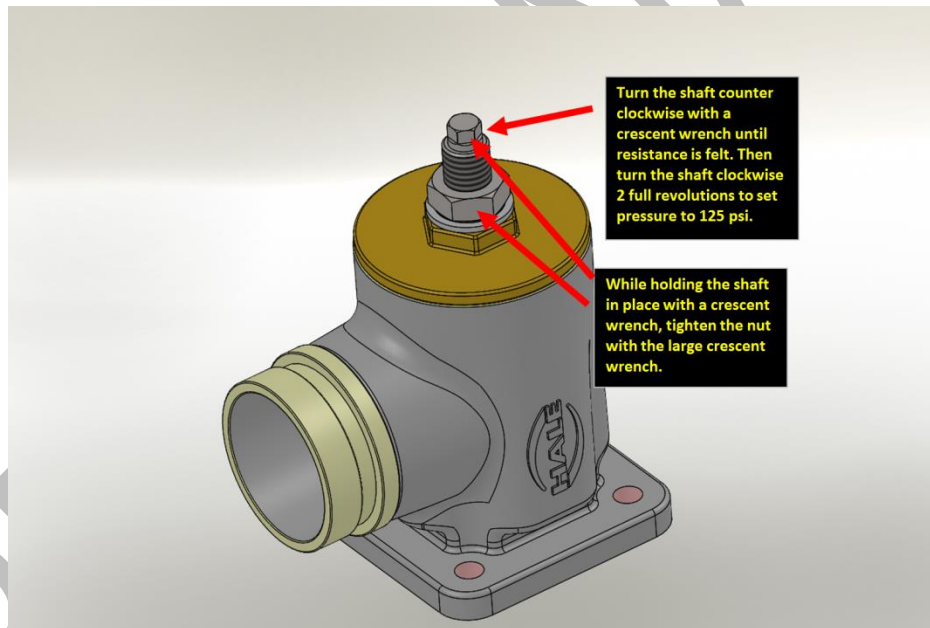
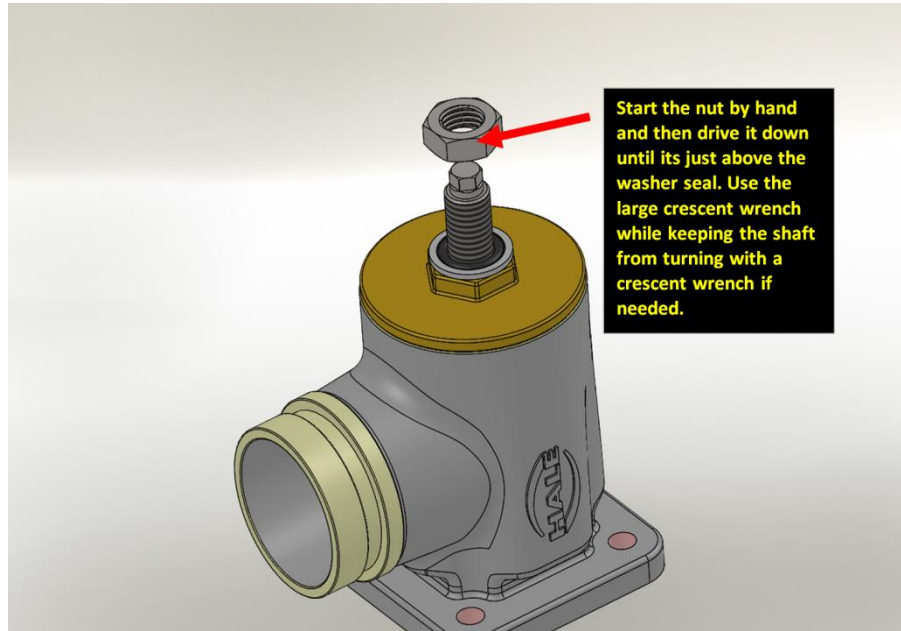

REV	DATE	BY	DESCRIPTION	Approved By
A	13FEB2018	SBL	PRELIMINARY	

 607 NW 27th Ave Ocala, FL 34475 Phone : (352) 629-5020 Fax : (352)-629-2902	REBUILD INSTRUCTIONS (PRELIMINARY)				P/N	SB-161
	TYPE	INTAKE RELIEF VALVE			PAGE	9 OF 9
	DEPARTMENT	ACCESSORIES	BY	SEAN LYONS	REV	A

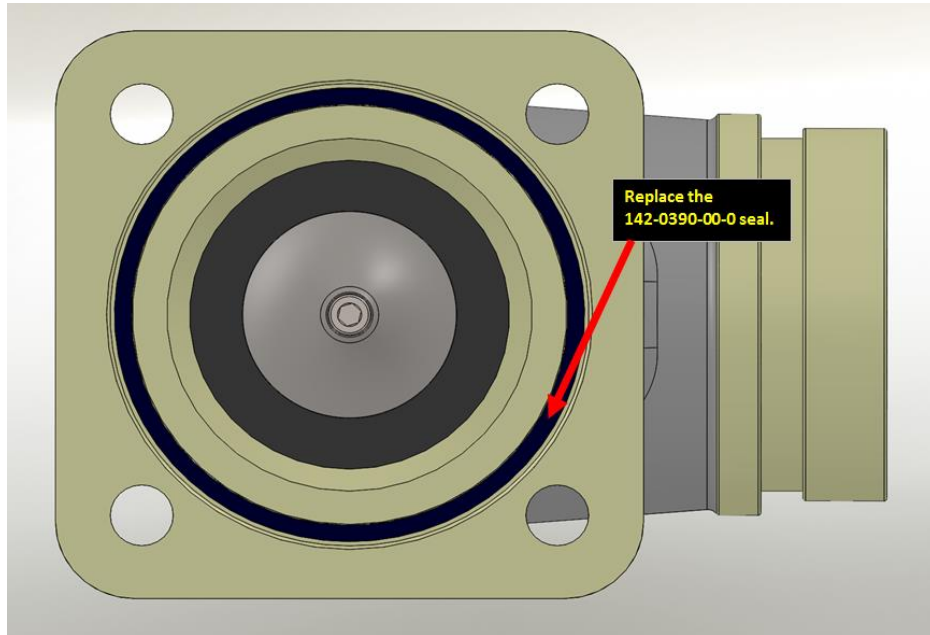

Conclude this replacement by remounting the intake relief valve on the pump, repeating this procedure on any other desired intake relief valves on the pump, and lastly conducting a standard pump air leak test.

REV	DATE	BY	DESCRIPTION	Approved By
A	13FEB2018	SBL	PRELIMINARY	