



Hale Products, Inc. Service Bulletins

Bulletin#: SB-122 **Revision#:** A **Date:** 23SEP2013

Product Type Covered:

<input type="checkbox"/>	Vehicle Mounted Pump	<input type="checkbox"/>	Valve
<input type="checkbox"/>	Portable Pump	<input type="checkbox"/>	Refueler Pump
<input checked="" type="checkbox"/>	Pump End	<input type="checkbox"/>	CAFS
<input type="checkbox"/>	Foam Proportioners	<input type="checkbox"/>	Parts and/or Accessory

Keywords: 80FCK; gearbox; oil; fill; level; vertical position

Product Covered:

80FCK Engine-Driven Pump Gearbox – Vertical Gearbox Orientation

Problem Statement:

80FCK pump gearboxes in the vertical (engine shaft above pump shaft) have been shipped without the proper gearbox oil fill level pipe assembly. Without this pipe assembly, customers will not be able to accurately check the oil level inside the gearbox. If not enough oil is added after the recommended annual gearbox oil change, the gearbox could reach temperatures high enough to damage internal components.

Written by: ANTHONY GLEATON **Date:** 26SEP2013

Approved by: ROB BELSER

Product Manager: JEFF VAN METER

Body of the Bulletin

Verification of Gearbox

- 1) Factory Assembly Check
 - a. If your 80FCK gearbox has the pipe assembly shown in Figure 1 below, you have the correct, factory installed gearbox oil level assembly. This assembly will be painted the same color as your pump.

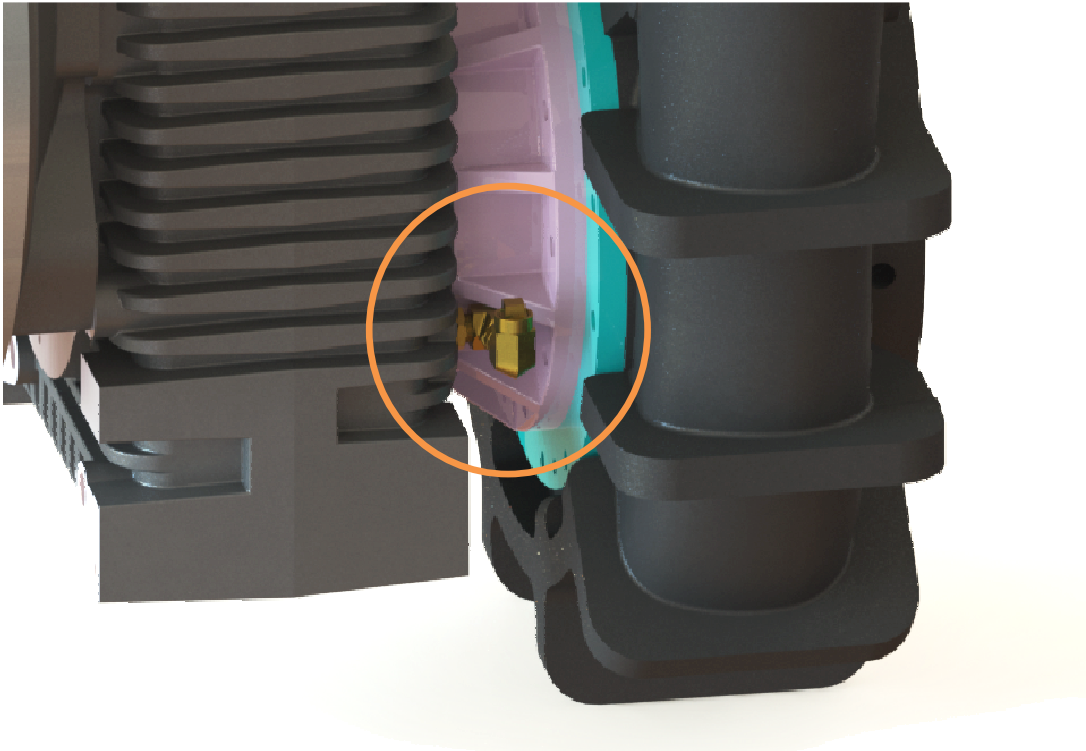

Figure 1 - Oil Fill Level Assembly - Factory Install Check (brass color shown for clarity)

2) Retrofit Kit Assembly Check

- a. If your 80FCK gearbox has the pipe assembly shown in Figure 2 below, you already have the retrofit gearbox oil level assembly installed. This assembly will have brass components and typically not painted to match your pump.

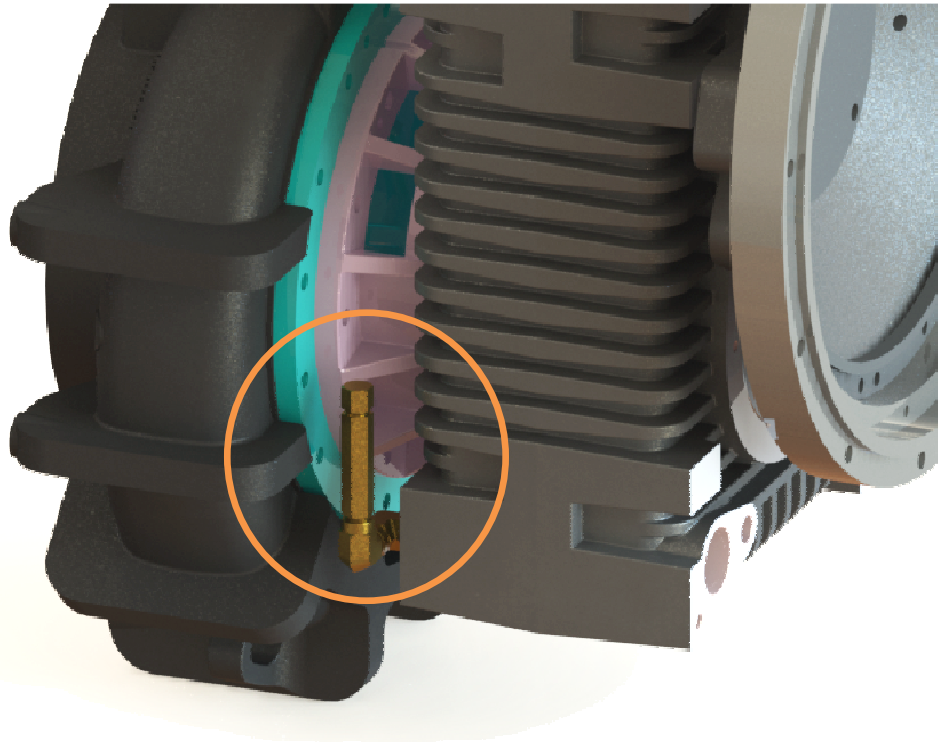

Figure 2 - Oil Fill Level Assembly - Retrofit Kit Install Check

3) Order Retrofit Kit

- a. If your 80FCK gearbox does not have either the factory or retrofit oil level pipe assembly installed, please contact Hale Products customer service with your pump serial number and reference this service bulletin. You will promptly be shipped the retrofit oil level pipe assembly (part number 582-00025). Please coordinate the installation with a Factory Authorized Service Center.

Installation of Retrofit Kit

As shown in Figures 3 and 4 below, assemble and install the retrofit gearbox oil level assembly on the bottom, right side of the pump gearbox, when looking at the suction inlet of the pump. Use the Loctite 806 threadlocker included with the kit as needed on all fittings, except the cap. The 80FCK pump uses Hale's BK gearbox assembly. The brass elbow and nipple act like an oil level tube. When filled to the top of the nipple, it offers the correct quantity of oil required for reliable gearbox operation.

To properly fill the BK gearbox, remove the cap from the oil level assembly. Remove the vent from the vent tube in the top of the gearbox. Oil should be added through the gearbox vent tube until oil spills out the top of the 4" nipple. The cap should then be reinstalled on the nipple and tightened to prevent oil leaks. Re-install the vent into the vent tube. **Oil should NOT be added through the oil level assembly** – air pockets can get trapped in the pipe assembly, creating a false reading of the oil level. If the gearbox does not contain the proper amount of oil, serious damage and failure can occur.

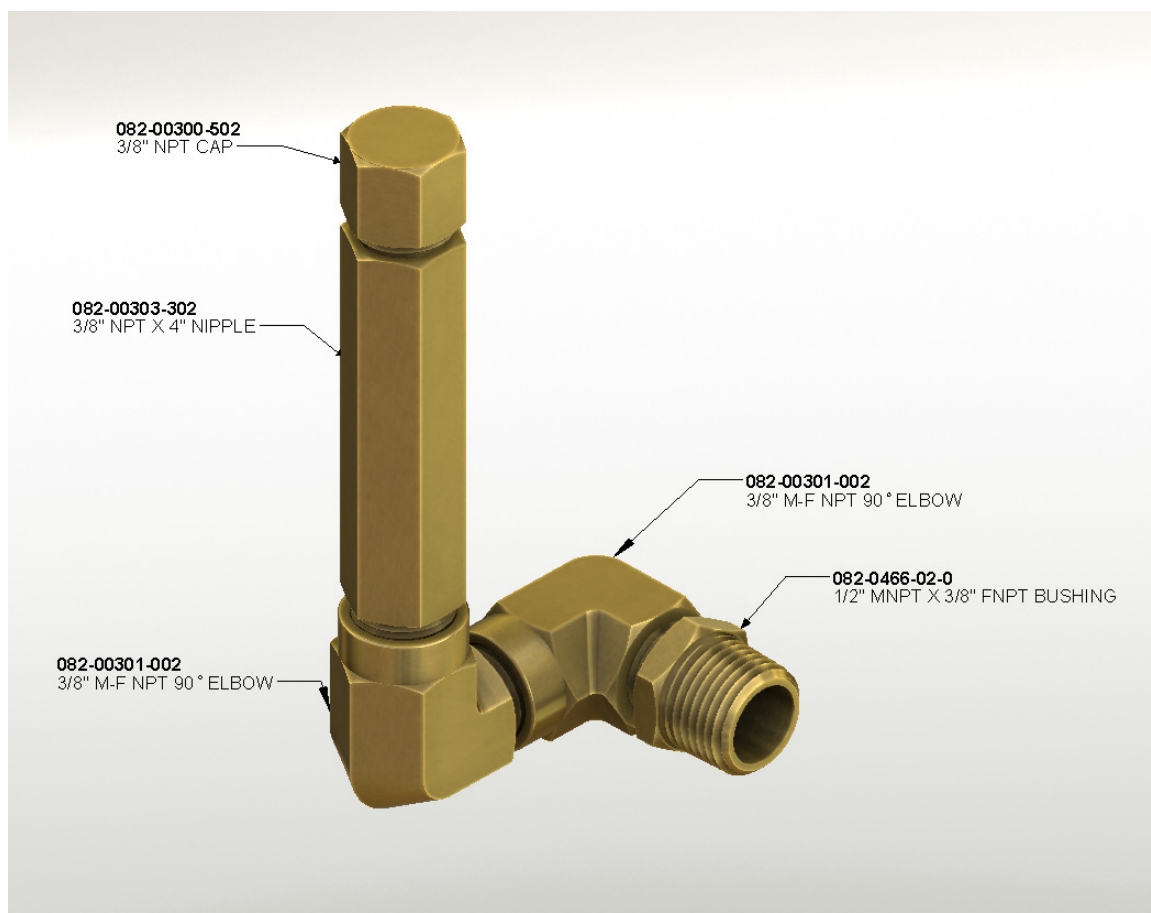

Figure 3 – Part Number 582-00025 - Retrofit Kit Assembly

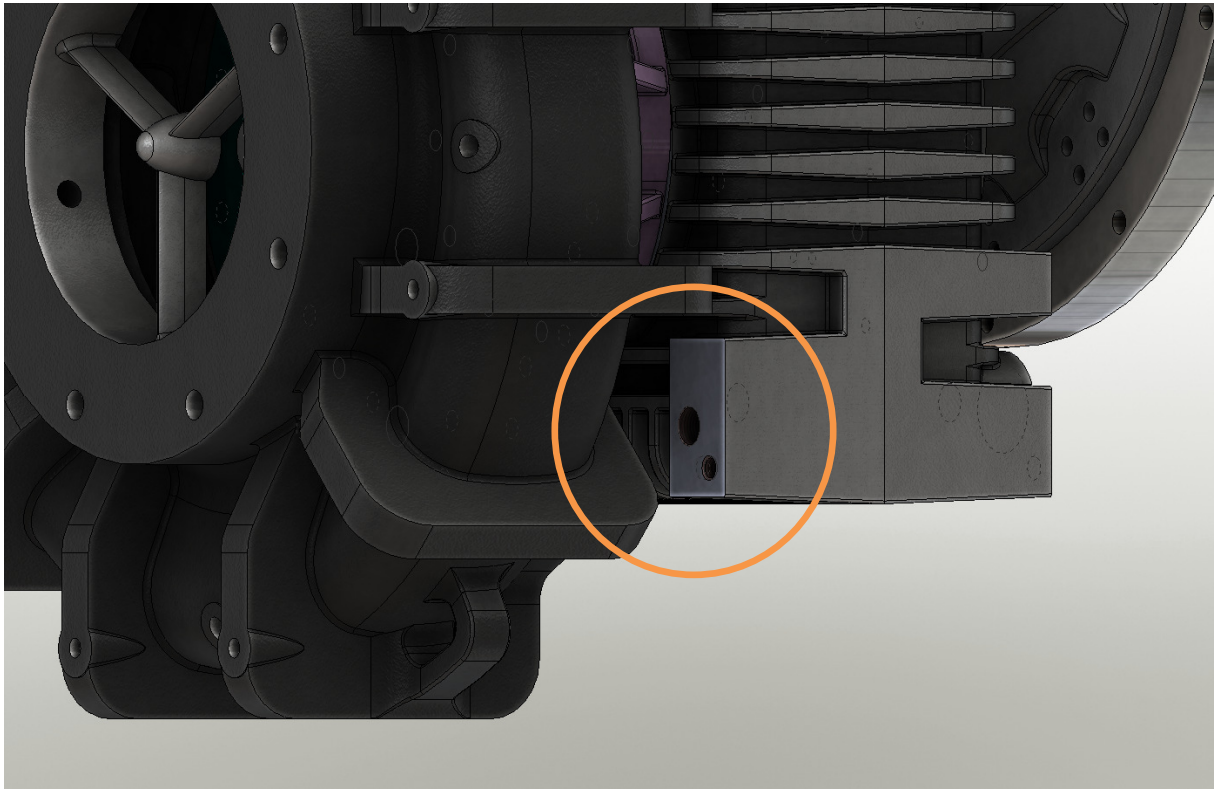

Figure 4 - Retrofit Kit Install Location

For additional information or assistance, please contact Hale Product Customer Service at 1-800-533-3569.