

# HALE SAE "C" DRIVE ADAPTER FOR "G" SERIES GEARBOXES

PLATE NO. 1200BA

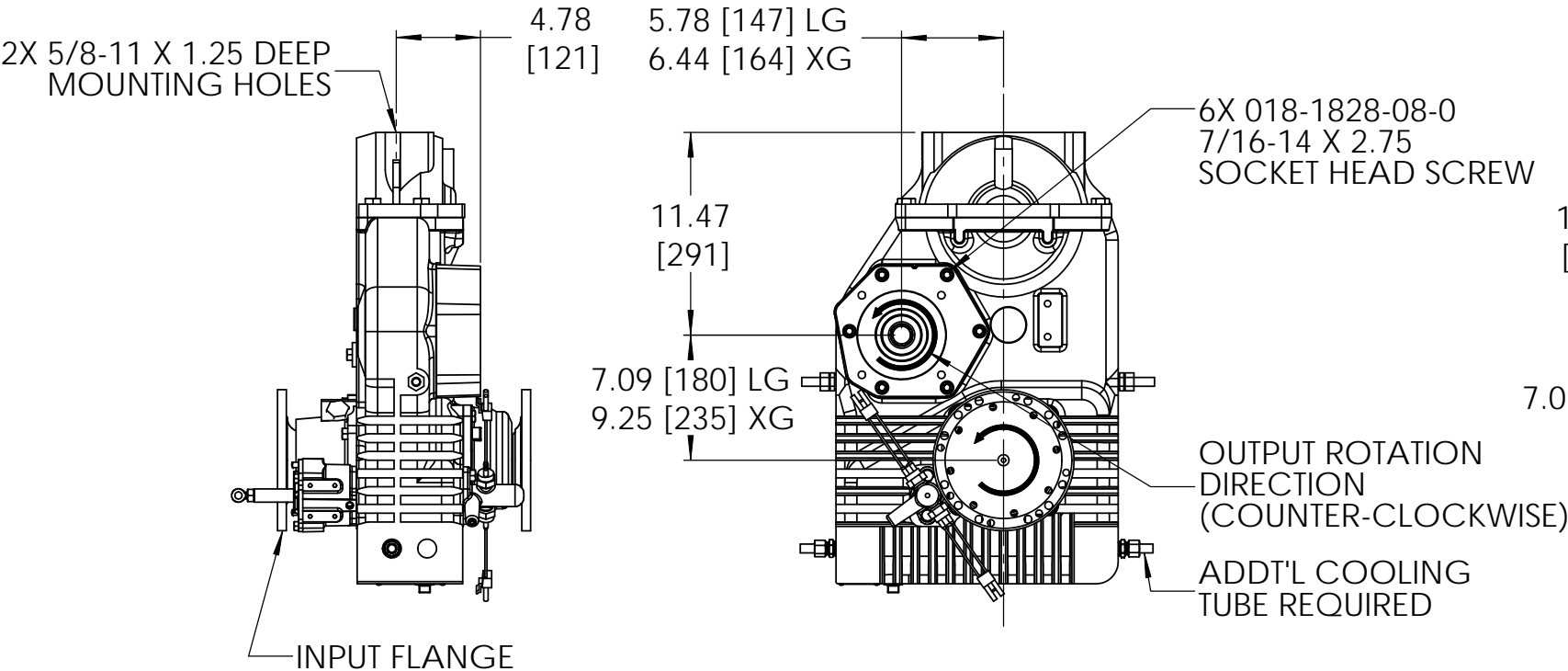

LG & XG GEARBOX

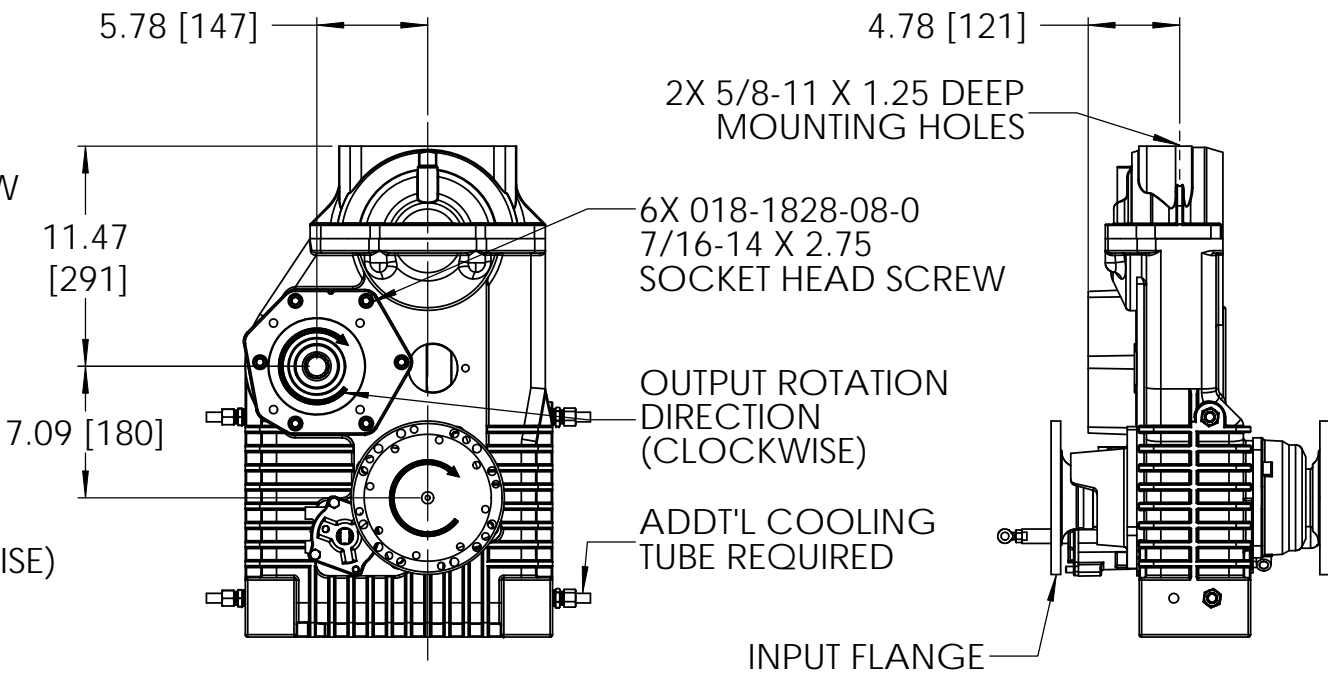

RG GEARBOX

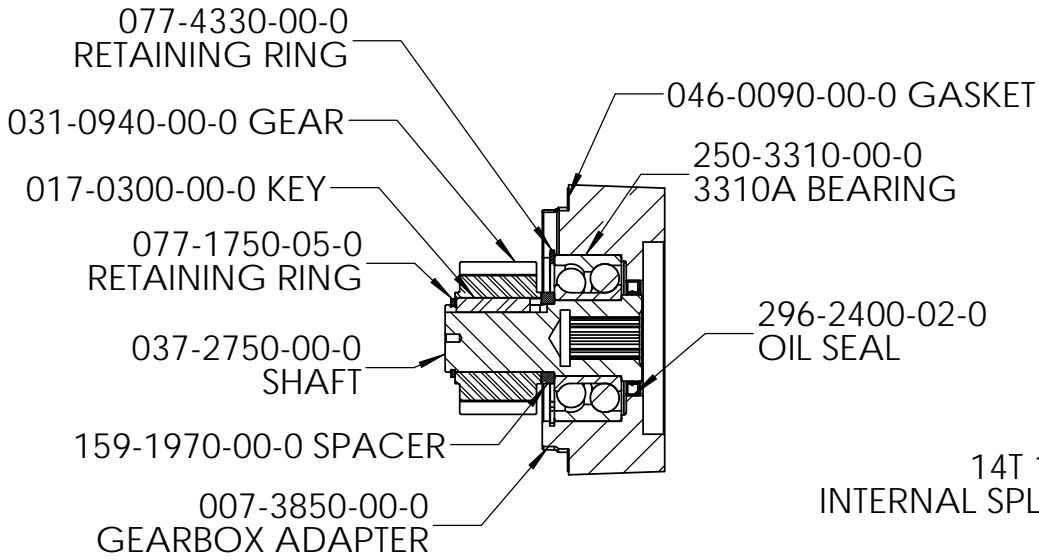

SECTION A-A

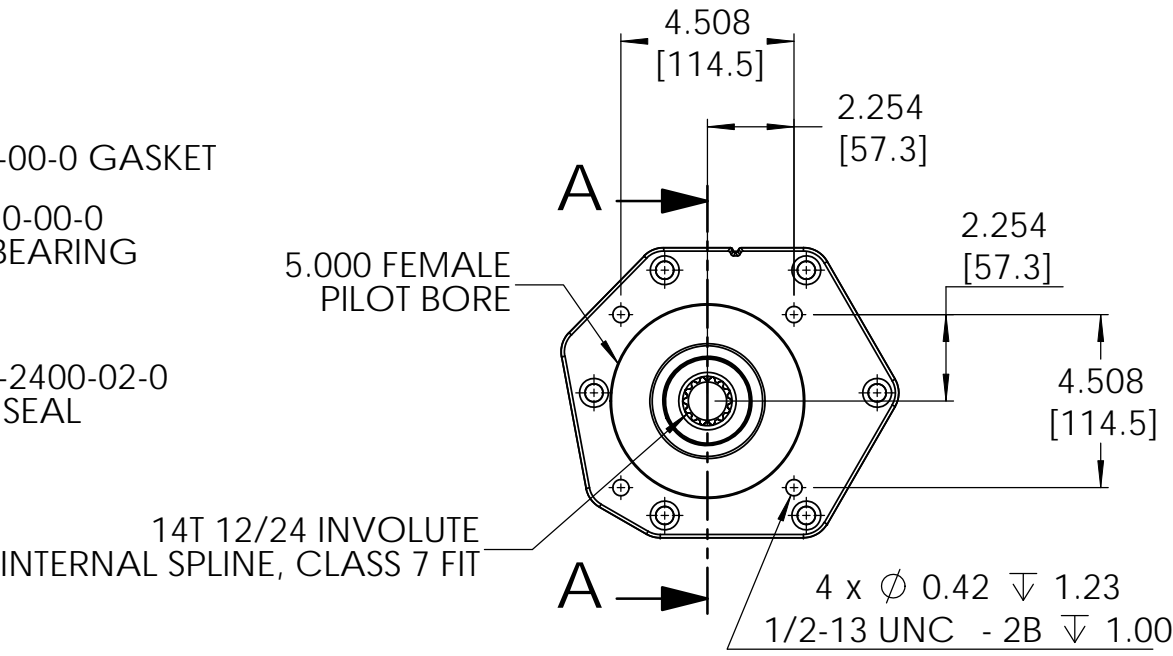

- NOTES:
- 1) SAE C DRIVE IS CAPABLE OF 75 HP MAXIMUM.
  - 2) DIMENSIONS ARE IN INCHES AND [MILLIMETERS].
  - 3) XG GEAR RATIO - 2.32:1  
LG & RG GEAR RATIO - 1.86:1
  - 4) ARROWS SHOW DIRECTION OF OUTPUT ROTATION.
  - 5) BUILDER IS REQUIRED TO ADD GEARBOX SUPPORT BRACKET TO ENSURE THE ADDITIONAL WEIGHT OF HYDRAULIC PUMP DOES NOT DAMAGE THE PUMP REAR BEARING HOUSING.
  - 6) SEE LATEST REVISION OF PL766 AND PL914 FOR GEARBOX INSTALLATION DIMENSIONS.

PLATE NO. 1200BA

ECN NO	REV	CHANGED FROM	BY	DATE	APVD
1077	A	REDESIGNED PL1200AA	JRP	08-01-11	JRP



HALE PRODUCTS, INC.  
A Unit of IDEX Corporation  
Conshohocken, PA 19428 USA

COPYRIGHT ©  
NOT TO BE REPRODUCED OR USED TO  
MAKE OTHER DRAWINGS OR MACHINERY

DRAWN JRP  
CHECKED JRP

DATE 08-01-11

SCALE: 1/10

SIZE  
B

SHEET 1 OF 1