

INSTRUCTION PLATE

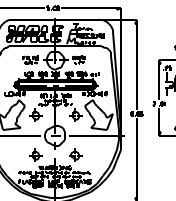

PANEL CUTOUP

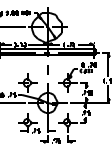

INSTRUCTIONS FOR INSTALLING LIGHT SWITCH RELIEF VALVE ON OG OR P35 RELIEF VALVE

1. MAKE SURE THE PUMP IS STOPPED AND THE SYSTEM IS DEPRESSURED BEFORE ATTEMPTING TO INSTALL THE VALVE.
2. REMOVE THE PUMP GUARD AND THE PUMP HOUSING COVER TO EXPOSE THE PUMP HOUSING.
3. IDENTIFY THE PUMP HOUSING COVER AND THE PUMP HOUSING. THE PUMP HOUSING COVER IS THE COVER THAT IS REMOVED TO ACCESS THE PUMP HOUSING.
4. REMOVE THE PUMP HOUSING COVER AND THE PUMP HOUSING. THE PUMP HOUSING COVER IS THE COVER THAT IS REMOVED TO ACCESS THE PUMP HOUSING.
5. IDENTIFY THE PUMP HOUSING COVER AND THE PUMP HOUSING. THE PUMP HOUSING COVER IS THE COVER THAT IS REMOVED TO ACCESS THE PUMP HOUSING.
6. REMOVE THE PUMP HOUSING COVER AND THE PUMP HOUSING. THE PUMP HOUSING COVER IS THE COVER THAT IS REMOVED TO ACCESS THE PUMP HOUSING.

INSTRUCTIONS FOR INSTALLING LIGHT SWITCH RELIEF VALVE ON P35 RELIEF VALVE

1. MAKE SURE THE PUMP IS STOPPED AND THE SYSTEM IS DEPRESSURED BEFORE ATTEMPTING TO INSTALL THE VALVE.
2. REMOVE THE PUMP GUARD AND THE PUMP HOUSING COVER TO EXPOSE THE PUMP HOUSING.
3. IDENTIFY THE PUMP HOUSING COVER AND THE PUMP HOUSING. THE PUMP HOUSING COVER IS THE COVER THAT IS REMOVED TO ACCESS THE PUMP HOUSING.
4. REMOVE THE PUMP HOUSING COVER AND THE PUMP HOUSING. THE PUMP HOUSING COVER IS THE COVER THAT IS REMOVED TO ACCESS THE PUMP HOUSING.
5. IDENTIFY THE PUMP HOUSING COVER AND THE PUMP HOUSING. THE PUMP HOUSING COVER IS THE COVER THAT IS REMOVED TO ACCESS THE PUMP HOUSING.
6. REMOVE THE PUMP HOUSING COVER AND THE PUMP HOUSING. THE PUMP HOUSING COVER IS THE COVER THAT IS REMOVED TO ACCESS THE PUMP HOUSING.

INSTRUCTIONS FOR INSTALLING LIGHT SWITCH RELIEF VALVE ON P35 RELIEF VALVE

1. MAKE SURE THE PUMP IS STOPPED AND THE SYSTEM IS DEPRESSURED BEFORE ATTEMPTING TO INSTALL THE VALVE.
2. REMOVE THE PUMP GUARD AND THE PUMP HOUSING COVER TO EXPOSE THE PUMP HOUSING.
3. IDENTIFY THE PUMP HOUSING COVER AND THE PUMP HOUSING. THE PUMP HOUSING COVER IS THE COVER THAT IS REMOVED TO ACCESS THE PUMP HOUSING.
4. REMOVE THE PUMP HOUSING COVER AND THE PUMP HOUSING. THE PUMP HOUSING COVER IS THE COVER THAT IS REMOVED TO ACCESS THE PUMP HOUSING.
5. IDENTIFY THE PUMP HOUSING COVER AND THE PUMP HOUSING. THE PUMP HOUSING COVER IS THE COVER THAT IS REMOVED TO ACCESS THE PUMP HOUSING.
6. REMOVE THE PUMP HOUSING COVER AND THE PUMP HOUSING. THE PUMP HOUSING COVER IS THE COVER THAT IS REMOVED TO ACCESS THE PUMP HOUSING.

INSTRUCTIONS FOR INSTALLING LIGHT SWITCH RELIEF VALVE ON P35 RELIEF VALVE

1. MAKE SURE THE PUMP IS STOPPED AND THE SYSTEM IS DEPRESSURED BEFORE ATTEMPTING TO INSTALL THE VALVE.
2. REMOVE THE PUMP GUARD AND THE PUMP HOUSING COVER TO EXPOSE THE PUMP HOUSING.
3. IDENTIFY THE PUMP HOUSING COVER AND THE PUMP HOUSING. THE PUMP HOUSING COVER IS THE COVER THAT IS REMOVED TO ACCESS THE PUMP HOUSING.
4. REMOVE THE PUMP HOUSING COVER AND THE PUMP HOUSING. THE PUMP HOUSING COVER IS THE COVER THAT IS REMOVED TO ACCESS THE PUMP HOUSING.
5. IDENTIFY THE PUMP HOUSING COVER AND THE PUMP HOUSING. THE PUMP HOUSING COVER IS THE COVER THAT IS REMOVED TO ACCESS THE PUMP HOUSING.
6. REMOVE THE PUMP HOUSING COVER AND THE PUMP HOUSING. THE PUMP HOUSING COVER IS THE COVER THAT IS REMOVED TO ACCESS THE PUMP HOUSING.

INSTRUCTIONS FOR INSTALLING LIGHT SWITCH RELIEF VALVE ON P35 RELIEF VALVE

1. MAKE SURE THE PUMP IS STOPPED AND THE SYSTEM IS DEPRESSURED BEFORE ATTEMPTING TO INSTALL THE VALVE.
2. REMOVE THE PUMP GUARD AND THE PUMP HOUSING COVER TO EXPOSE THE PUMP HOUSING.
3. IDENTIFY THE PUMP HOUSING COVER AND THE PUMP HOUSING. THE PUMP HOUSING COVER IS THE COVER THAT IS REMOVED TO ACCESS THE PUMP HOUSING.
4. REMOVE THE PUMP HOUSING COVER AND THE PUMP HOUSING. THE PUMP HOUSING COVER IS THE COVER THAT IS REMOVED TO ACCESS THE PUMP HOUSING.
5. IDENTIFY THE PUMP HOUSING COVER AND THE PUMP HOUSING. THE PUMP HOUSING COVER IS THE COVER THAT IS REMOVED TO ACCESS THE PUMP HOUSING.
6. REMOVE THE PUMP HOUSING COVER AND THE PUMP HOUSING. THE PUMP HOUSING COVER IS THE COVER THAT IS REMOVED TO ACCESS THE PUMP HOUSING.

INSTRUCTION PLATE AND PANEL MOUNTING DETAILS

MAINTENANCE INSTRUCTIONS

THE PUMP HOUSING COVER IS THE COVER THAT IS REMOVED TO ACCESS THE PUMP HOUSING. THE PUMP HOUSING COVER IS THE COVER THAT IS REMOVED TO ACCESS THE PUMP HOUSING. THE PUMP HOUSING COVER IS THE COVER THAT IS REMOVED TO ACCESS THE PUMP HOUSING.

ELECTRICAL INFORMATION

THE PUMP HOUSING COVER IS THE COVER THAT IS REMOVED TO ACCESS THE PUMP HOUSING. THE PUMP HOUSING COVER IS THE COVER THAT IS REMOVED TO ACCESS THE PUMP HOUSING. THE PUMP HOUSING COVER IS THE COVER THAT IS REMOVED TO ACCESS THE PUMP HOUSING.

DRAIN CONNECTION NOTES

THE PUMP HOUSING COVER IS THE COVER THAT IS REMOVED TO ACCESS THE PUMP HOUSING. THE PUMP HOUSING COVER IS THE COVER THAT IS REMOVED TO ACCESS THE PUMP HOUSING. THE PUMP HOUSING COVER IS THE COVER THAT IS REMOVED TO ACCESS THE PUMP HOUSING.

FOR WIRING AND TUBING CONNECTIONS SEE PL 743

THIS PRODUCT IS THE PROPERTY OF B. F. GOODRICH, 4-633-00

HALE TYPE TPM AND TPOA RELIEF VALVE SYSTEM

"PATENTED"

PLATE NO. 742ED

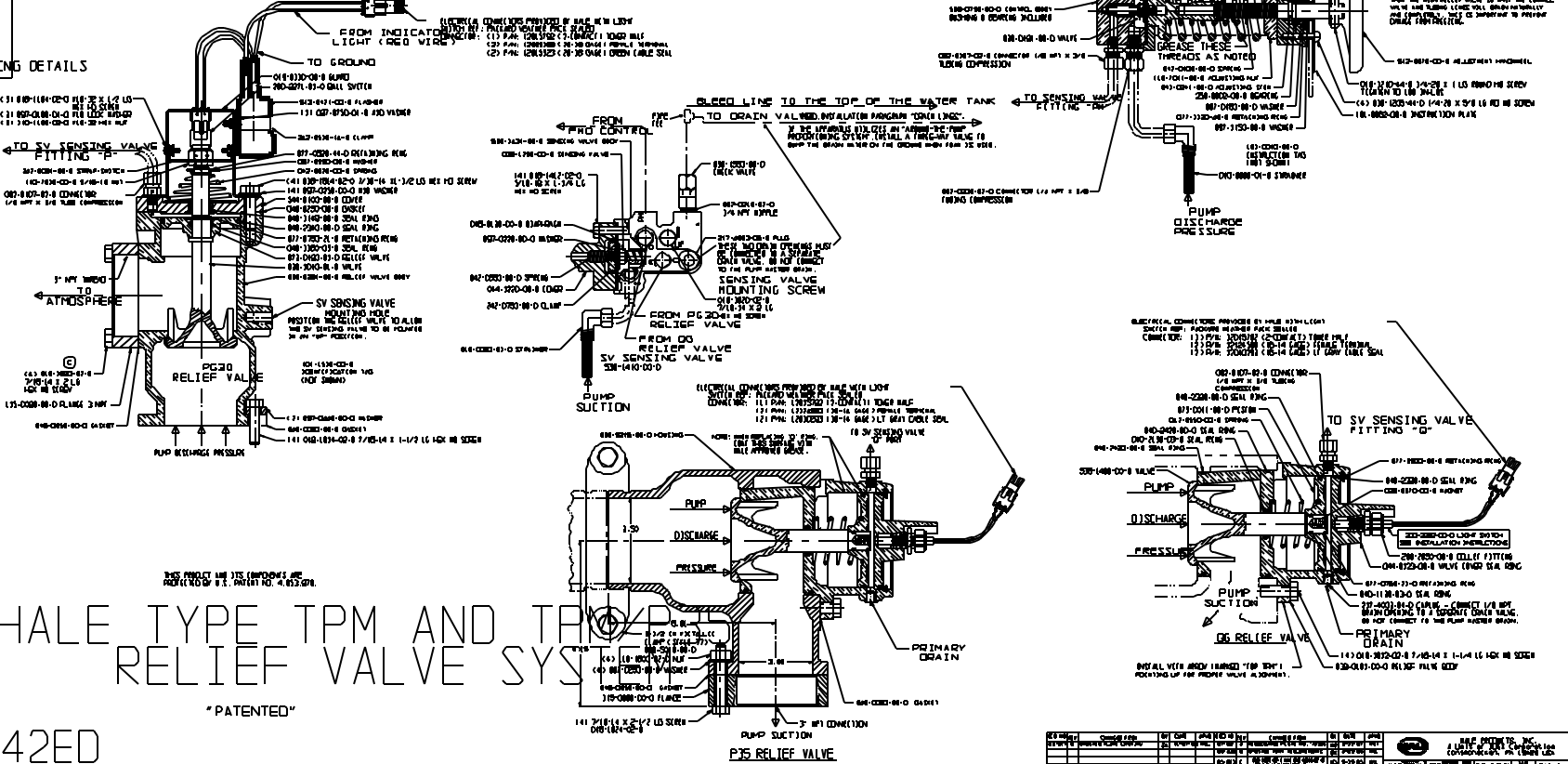

REV	DATE	DESCRIPTION	BY	CHKD	APP'D
1					
2					
3					
4					
5					
6					
7					
8					
9					
10					

