

HALE TYPE MBP SILENCER SERIES PUMP

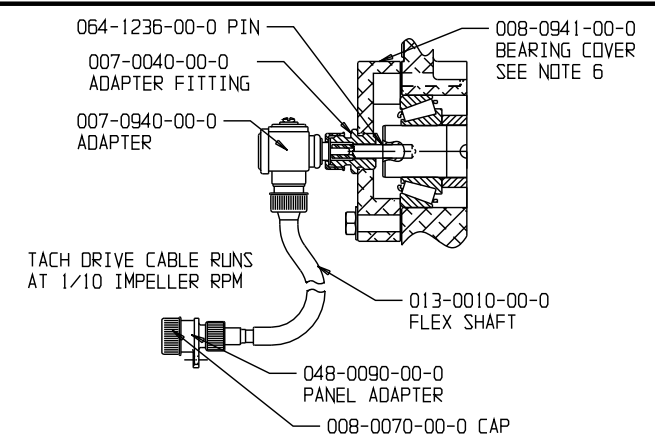

OPTIONAL TACHOMETER DRIVE

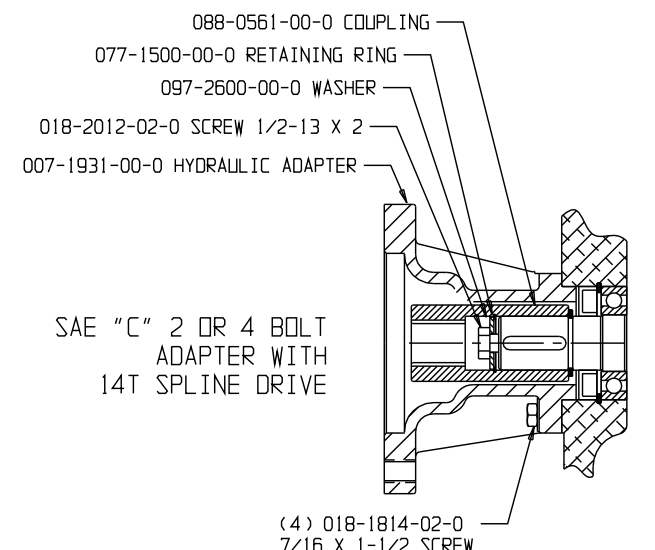

MBPH HYDRAULIC DRIVE

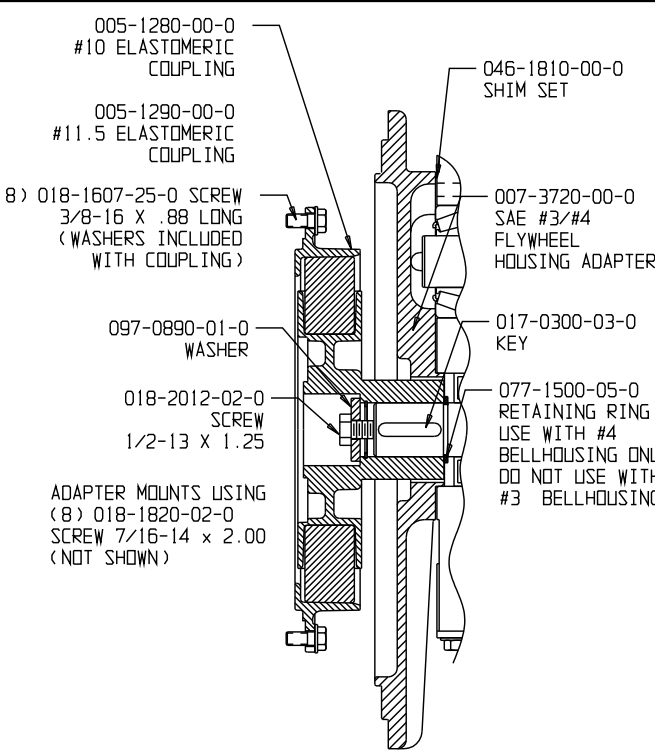

MBPM ENGINE DRIVE

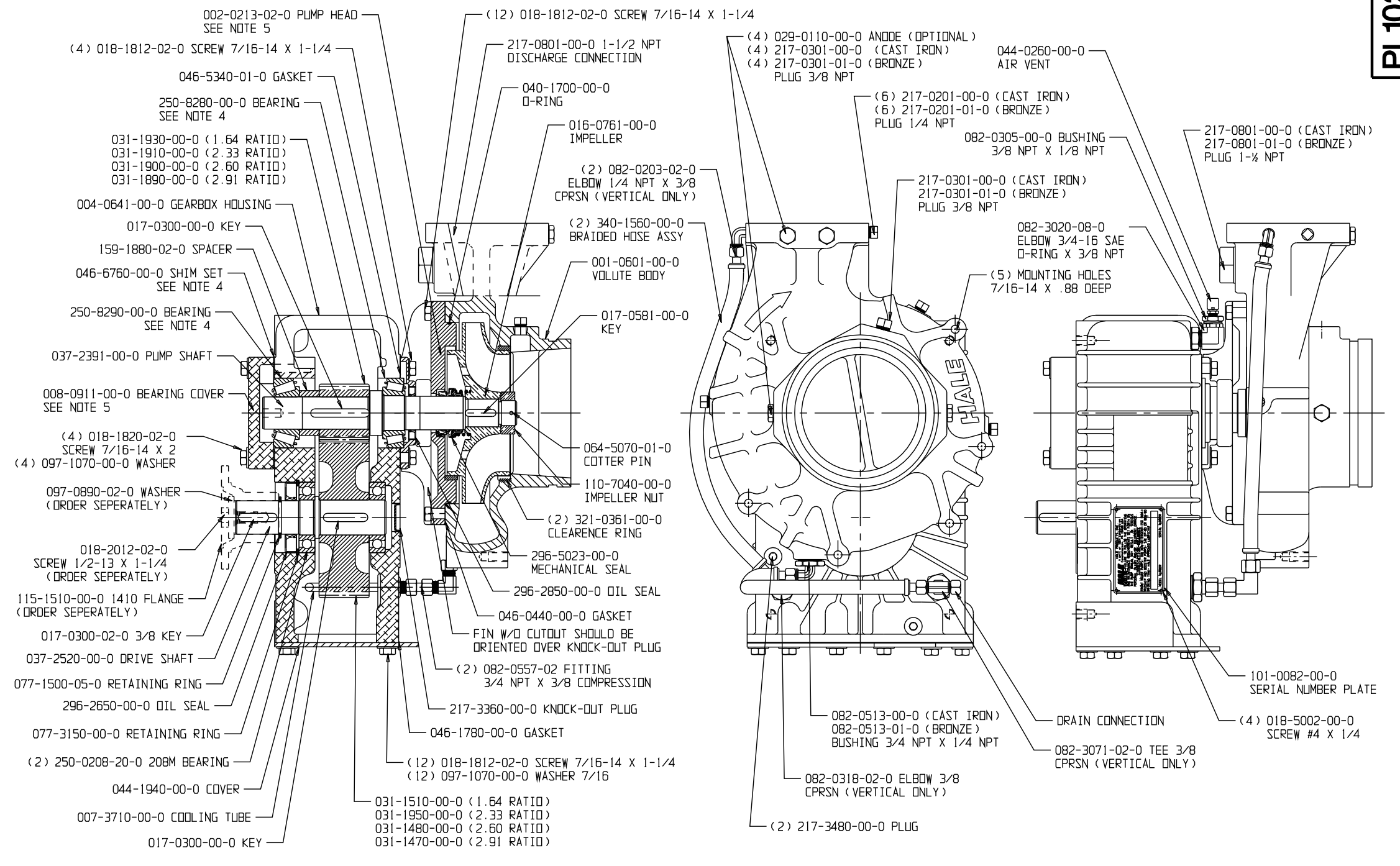

NOTES:

- 1) CAUTION: ALL FASTENERS ON THIS UNIT HAVE BEEN SELECTED PER THEIR APPLICATION. HALE PRODUCTS DOES NOT RECOMMEND REPLACING FASTENERS WITH ANYTHING OTHER THAN HALE PART NUMBERS PROVIDED. REPLACING WITH A WEAKER ALTERNATIVE POSES A SAFETY RISK.
- 2) ALL FASTENERS SHALL BE INSTALLED WITH A THREAD LOCKING ANAEROBIC ADHESIVE/SEALANT: LOCTITE #246 HIGH TEMPERATURE THREADLOCKER OR EQUIVALENT.
- 3) MECHANICAL SEALS ARE TO BE INSTALLED USING PAC-EASE RUBBER LUBRICANT EMULSION OR EQUIVALENT, A SOFT, CLEAN PUSHER TUBE, AND A SEAL RAMP.
- 4) BASED ON GEARBOX ORIENTATION, MOUNT DRAIN PLUG IN LOWEST OF FOUR 3/4-16 PORTS. INSTALL BREATHER VENT IN HIGHEST PORT. INSTALL PLUGS IN REMAINING 2 PORTS.
- 5) SET BEARING ENDPLAY ON PUMP SHAFT TO .003 - .005 USING SHIMS FROM 046-6760-00-0 SHIM SET.
- 6) INSTALL BEARING COVER AND PUMP HEAD SO THAT OILING SLOT IS FACING UP BASED ON THE SPECIFIED ORIENTATION.
- 7) FOR MOUNTING DIMENSIONS, SUCTION/DISCHARGE OPTIONS AND ANODE/THERMAL RELIEF VALVE OPTIONS, SEE LATEST REVISION OF PLATE NO. 1116.

TORQUE TABLE

SCREW SIZE	GRADE 5		GRADE 8	
	lbs-ft	Nm	lbs-ft	Nm
1/4-20	8	11	12	16
5/16-18	17	22	25	33
3/8-16	30	41	45	61
7/16-14	50	67	70	94
1/2-20	90	122	120	162
3/4-10	260	352	380	514

ECD NO	REV	CHANGED FROM	BY	DATE	APVD	ECD NO	REV	CHANGED FROM	BY	DATE	APVD
						0879	A	REDESIGNED PL1026B	JRP	03-26-09	MAL



HALE PRODUCTS, INC.
A Unit of IDEX Corporation
Conshohocken, PA 19428 USA

COPYRIGHT © NOT TO BE REPRODUCED OR USED TO MAKE OTHER DRAWINGS OR MACHINERY. DRAWN JRP CHECKED MAL DATE 03-26-09 SIZE NTS SCALE : NTS

PLATE NO. 1026CA